

Digital monitoring relay Asymmetry 0-20% Phase sequence can be activated Phase failure 3 x 160 to 690 V 50 to 60 Hz AC Undervoltage 160-690 V Hysteresis 1-20 V ON and OFF delay 0-20 s 2 change-over contacts screw terminal Successor product for 3UG3012-1A...



Product brand name	SIRIUS
Product designation	Network monitoring relay with digital setting
Design of the product	4 functions
Product type designation	3UG4

General technical data	
Product function	Phase monitoring relay
Display version LED	No
Design of the display	LCD
Degree of pollution	3
Type of voltage	
• for monitoring	AC
• of the control supply voltage	AC
Surge voltage resistance rated value	6 kV
Protection class IP	IP20
Shock resistance	
• acc. to IEC 60068-2-27	sinusoidal half-wave 15g / 11 ms
Mechanical service life (switching cycles)	
• typical	10 000 000
Electrical endurance (switching cycles)	

• at AC-15 at 230 V typical	100 000
<b>Thermal current of the switching element with contacts maximum</b>	5 A
<b>Reference code acc. to DIN 40719 extended according to IEC 204-2 acc. to IEC 750</b>	K
<b>Reference code acc. to DIN EN 81346-2</b>	K
<b>Reference code acc. to DIN EN 61346-2</b>	K
<b>Relative repeat accuracy</b>	1 %

### Product Function

<b>Product function</b>	
• undervoltage detection	Yes
• Overvoltage detection	No
• phase sequence recognition	Yes
• Phase failure detection	Yes
• Overvoltage detection 3 phase	No
• undervoltage detection 3 phases	Yes
• Voltage window recognition 3 phase	No
• Adjustable open/closed-circuit current principle	Yes
• Auto-reset	Yes

### Control circuit/ Control

<b>Control supply voltage at AC</b>	
• at 50 Hz rated value	160 ... 690 V
• at 60 Hz rated value	160 ... 690 V
<b>Operating range factor control supply voltage rated value at AC at 50 Hz</b>	
• initial value	1
• Full-scale value	1
<b>Operating range factor control supply voltage rated value at AC at 60 Hz</b>	
• initial value	1
• Full-scale value	1

### Measuring circuit

<b>Adjustable response delay time</b>	
• when starting	0.1 ... 20 s
• with lower or upper limit violation	0.1 ... 20 s
<b>Accuracy of digital display</b>	+/-1 digit

### Precision

<b>Relative metering precision</b>	5 %
------------------------------------	-----

### Auxiliary circuit

<b>Number of CO contacts</b>	
• delayed switching	2

<b>Operating frequency with 3RT2 contactor maximum</b>	5 000 1/h
<b>Main circuit</b>	
<b>Number of poles for main current circuit</b>	3
<b>Outputs</b>	
<b>Ampacity of the output relay at AC-15</b>	
• at 250 V at 50/60 Hz	3 A
• at 400 V at 50/60 Hz	3 A
<b>Ampacity of the output relay at DC-13</b>	
• at 24 V	1 A
• at 125 V	0.2 A
• at 250 V	0.1 A
<b>Operating current at 17 V minimum</b>	5 mA
<b>Continuous current of the DIAZED fuse link of the output relay</b>	4 A
<b>Electromagnetic compatibility</b>	
<b>Conducted interference</b>	
• due to burst acc. to IEC 61000-4-4	2 kV
• due to conductor-earth surge acc. to IEC 61000-4-5	2 kV
• due to conductor-conductor surge acc. to IEC 61000-4-5	1 kV
<b>Field-bound parasitic coupling acc. to IEC 61000-4-3</b>	10 V/m
<b>Electrostatic discharge acc. to IEC 61000-4-2</b>	6 kV contact discharge / 8 kV air discharge
<b>Galvanic isolation</b>	
<b>Galvanic isolation</b>	
• between entrance and outlet	Yes
• between the outputs	Yes
• between the voltage supply and other circuits	Yes
<b>Connections/Terminals</b>	
<b>Product function</b>	
• removable terminal for auxiliary and control circuit	Yes
<b>Type of electrical connection</b>	screw-type terminals
<b>Type of connectable conductor cross-sections</b>	
• solid	1x (0.5 ... 4 mm <sup>2</sup> ), 2x (0.5 ... 2.5 mm <sup>2</sup> )
• finely stranded with core end processing	1x (0.5 ... 2.5 mm <sup>2</sup> ), 2x (0.5 ... 1.5 mm <sup>2</sup> )
• at AWG conductors solid	2x (20 ... 14)
• at AWG conductors stranded	2x (20 ... 14)
<b>Connectable conductor cross-section</b>	
• solid	0.5 ... 4 mm <sup>2</sup>
• finely stranded with core end processing	0.5 ... 2.5 mm <sup>2</sup>

<b>AWG number as coded connectable conductor cross section</b>	
• solid	20 ... 14
• stranded	20 ... 14
<b>Tightening torque</b>	
• with screw-type terminals	0.8 ... 1.2 N·m





### Installation/ mounting/ dimensions

<b>Mounting position</b>	any
<b>Mounting type</b>	snap-on mounting
<b>Height</b>	92 mm
<b>Width</b>	22.5 mm
<b>Depth</b>	91 mm
<b>Required spacing</b>	
• with side-by-side mounting	
— forwards	0 mm
— Backwards	0 mm
— upwards	0 mm
— downwards	0 mm
— at the side	0 mm
• for grounded parts	
— forwards	0 mm
— Backwards	0 mm
— upwards	0 mm
— at the side	0 mm
— downwards	0 mm
• for live parts	
— forwards	0 mm
— Backwards	0 mm
— upwards	0 mm
— downwards	0 mm
— at the side	0 mm

### Ambient conditions

<b>Installation altitude at height above sea level</b>	
• maximum	2 000 m

### Certificates/approvals

General Product Approval		EMC	Declaration of Conformity	
 CCC	 UL		 RCM	 EG-Konf.

[Miscellaneous](#)

Test Certificates	Marine / Shipping	other	Railway
<a href="#">Special Test Certificate</a>	 LRS	<a href="#">Confirmation</a>	<a href="#">Vibration and Shock</a>
<a href="#">Type Test Certificates/Test Report</a>	 DNVGL.COM/AF		

#### Further information

##### Information- and Downloadcenter (Catalogs, Brochures,...)

<http://www.siemens.com/industrial-controls/catalogs>

##### Industry Mall (Online ordering system)

<https://mall.industry.siemens.com/mall/en/en/Catalog/product?mlfb=3UG4614-1BR20>

##### Cax online generator

<http://support.automation.siemens.com/WW/CAXorder/default.aspx?lang=en&mlfb=3UG4614-1BR20>

##### Service&Support (Manuals, Certificates, Characteristics, FAQs,...)

<https://support.industry.siemens.com/cs/ww/en/ps/3UG4614-1BR20>

##### Image database (product images, 2D dimension drawings, 3D models, device circuit diagrams, EPLAN macros, ...)

[http://www.automation.siemens.com/bilddb/cax\\_de.aspx?mlfb=3UG4614-1BR20&lang=en](http://www.automation.siemens.com/bilddb/cax_de.aspx?mlfb=3UG4614-1BR20&lang=en)

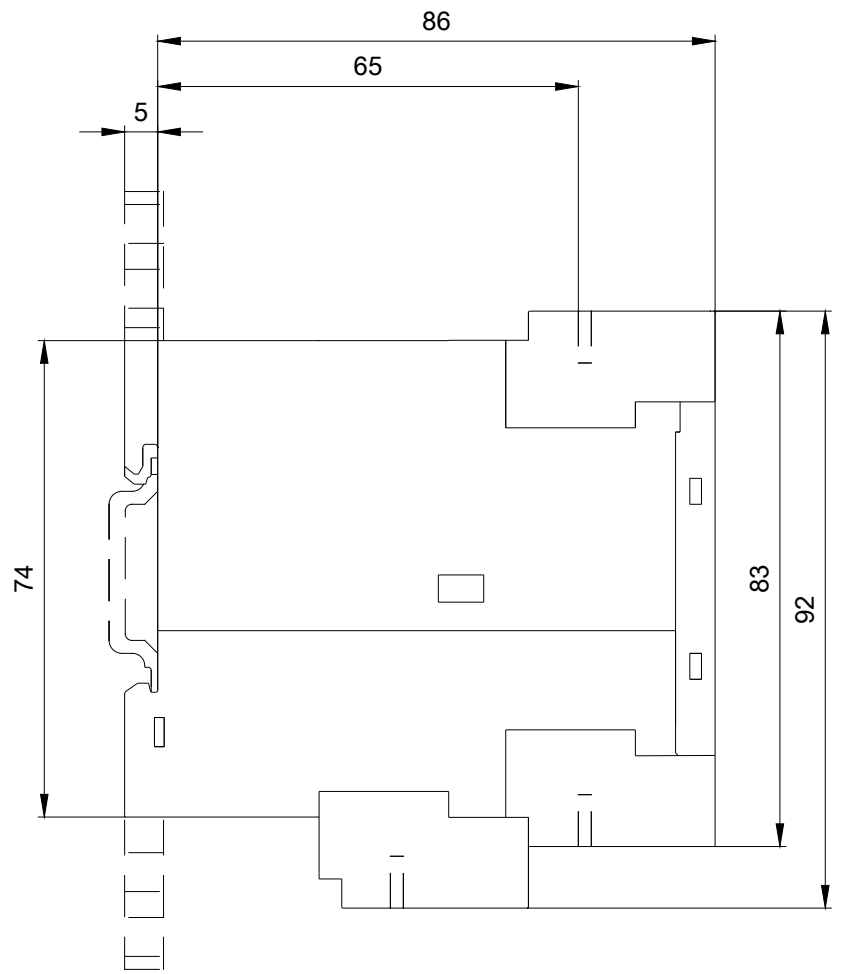
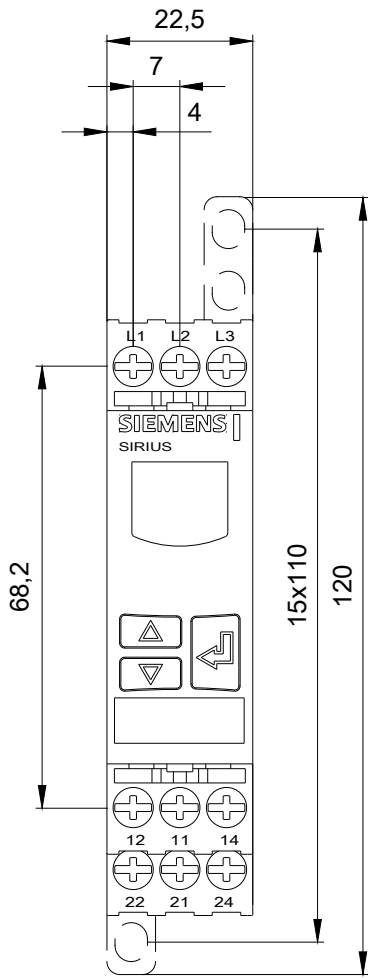

last modified:

06/06/2019