

Digital monitoring relay 3-phase supply voltage Autom. phase sequence correction Phase failure 3 x 160 to 690 V 50 to 60 Hz AC Undervoltage and overvoltage 160-690 V Hysteresis 1-20 V OFF delay 0-20 s Asymmetry 0-20% 1 CO for phase correction 1 CO for line supply faults screw terminal



Figure similar

Product brand name	SIRIUS
Product designation	Network monitoring relay with digital setting
Design of the product	5 functions
Product type designation	3UG4

General technical data	
Product function	Phase monitoring relay
Display version LED	No
Design of the display	LCD
Degree of pollution	3
Type of voltage	
• for monitoring	AC
• of the control supply voltage	AC
Surge voltage resistance rated value	6 kV
Protection class IP	IP20
Shock resistance	
• acc. to IEC 60068-2-27	sinusoidal half-wave 15g / 11 ms
Mechanical service life (switching cycles)	

• typical	10 000 000
Electrical endurance (switching cycles)	
• at AC-15 at 230 V typical	100 000
Thermal current of the switching element with contacts maximum	5 A
Reference code acc. to DIN 40719 extended according to IEC 204-2 acc. to IEC 750	K
Reference code acc. to DIN EN 81346-2	K
Reference code acc. to DIN EN 61346-2	K
Relative repeat accuracy	1 %

Product Function

Product function	
• undervoltage detection	Yes
• Overvoltage detection	Yes
• phase sequence recognition	Yes
• Phase failure detection	Yes
• Overvoltage detection 3 phase	Yes
• undervoltage detection 3 phases	Yes
• Voltage window recognition 3 phase	Yes
• Adjustable open/closed-circuit current principle	No
• Auto-reset	Yes

Control circuit/ Control

Control supply voltage at AC	
• at 50 Hz rated value	160 ... 690 V
• at 60 Hz rated value	160 ... 690 V
Operating range factor control supply voltage rated value at AC at 50 Hz	
• initial value	1
• Full-scale value	1
Operating range factor control supply voltage rated value at AC at 60 Hz	
• initial value	1
• Full-scale value	1

Measuring circuit

Adjustable response delay time	
• with lower or upper limit violation	0.1 ... 20 s
Accuracy of digital display	+/-1 digit

Precision

Relative metering precision	5 %
------------------------------------	-----

Auxiliary circuit

Number of CO contacts	
------------------------------	--

• delayed switching	2
Operating frequency with 3RT2 contactor maximum	5 000 1/h
Main circuit	
Number of poles for main current circuit	3
Outputs	
Ampacity of the output relay at AC-15	
• at 250 V at 50/60 Hz	3 A
• at 400 V at 50/60 Hz	3 A
Ampacity of the output relay at DC-13	
• at 24 V	1 A
• at 125 V	0.2 A
• at 250 V	0.1 A
Operating current at 17 V minimum	5 mA
Continuous current of the DIAZED fuse link of the output relay	4 A
Electromagnetic compatibility	
Conducted interference	
• due to burst acc. to IEC 61000-4-4	2 kV
• due to conductor-earth surge acc. to IEC 61000-4-5	2 kV
• due to conductor-conductor surge acc. to IEC 61000-4-5	1 kV
Field-bound parasitic coupling acc. to IEC 61000-4-3	10 V/m
Electrostatic discharge acc. to IEC 61000-4-2	6 kV contact discharge / 8 kV air discharge
Galvanic isolation	
Galvanic isolation	
• between entrance and outlet	Yes
• between the outputs	Yes
• between the voltage supply and other circuits	Yes
Connections/Terminals	
Product function	
• removable terminal for auxiliary and control circuit	Yes
Type of electrical connection	screw-type terminals
Type of connectable conductor cross-sections	
• solid	1x (0.5 ... 4 mm ²), 2x (0.5 ... 2.5 mm ²)
• finely stranded with core end processing	1x (0.5 ... 2.5 mm ²), 2x (0.5 ... 1.5 mm ²)
• at AWG conductors solid	2x (20 ... 14)
• at AWG conductors stranded	2x (20 ... 14)
Connectable conductor cross-section	
• solid	0.5 ... 4 mm ²

<ul style="list-style-type: none"> finely stranded with core end processing 	0.5 ... 2.5 mm ²
AWG number as coded connectable conductor cross section	
<ul style="list-style-type: none"> solid 	20 ... 14
<ul style="list-style-type: none"> stranded 	20 ... 14
Tightening torque	
<ul style="list-style-type: none"> with screw-type terminals 	0.8 ... 1.2 N·m





Installation/ mounting/ dimensions

Mounting position	any
Mounting type	snap-on mounting
Height	92 mm
Width	22.5 mm
Depth	91 mm
Required spacing	
<ul style="list-style-type: none"> with side-by-side mounting <ul style="list-style-type: none"> — forwards — Backwards — upwards — downwards — at the side for grounded parts <ul style="list-style-type: none"> — forwards — Backwards — upwards — at the side — downwards for live parts <ul style="list-style-type: none"> — forwards — Backwards — upwards — downwards — at the side 	0 mm 0 mm 0 mm 0 mm 0 mm 0 mm 0 mm 0 mm 0 mm 0 mm 0 mm 0 mm 0 mm 0 mm 0 mm

Ambient conditions

Installation altitude at height above sea level	
<ul style="list-style-type: none"> maximum 	2 000 m

Certificates/approvals

General Product Approval		EMC		Declaration of Conformity	
					Miscellaneous
CCC	UL		RCM	EG-Konf.	

Test Certificates		Marine / Shipping		other	Railway
Type Test Certificates/Test Report	Special Test Certificate			Confirmation	Vibration and Shock
		LRS	DNVGL.COM/AF		

Further information

Information- and Downloadcenter (Catalogs, Brochures,...)

<http://www.siemens.com/industrial-controls/catalogs>

Industry Mall (Online ordering system)

<https://mall.industry.siemens.com/mall/en/en/Catalog/product?mlfb=3UG4617-1CR20>

Cax online generator

<http://support.automation.siemens.com/WW/CAXorder/default.aspx?lang=en&mlfb=3UG4617-1CR20>

Service&Support (Manuals, Certificates, Characteristics, FAQs,...)

<https://support.industry.siemens.com/cs/ww/en/ps/3UG4617-1CR20>

Image database (product images, 2D dimension drawings, 3D models, device circuit diagrams, EPLAN macros, ...)

http://www.automation.siemens.com/bilddb/cax_de.aspx?mlfb=3UG4617-1CR20&lang=en

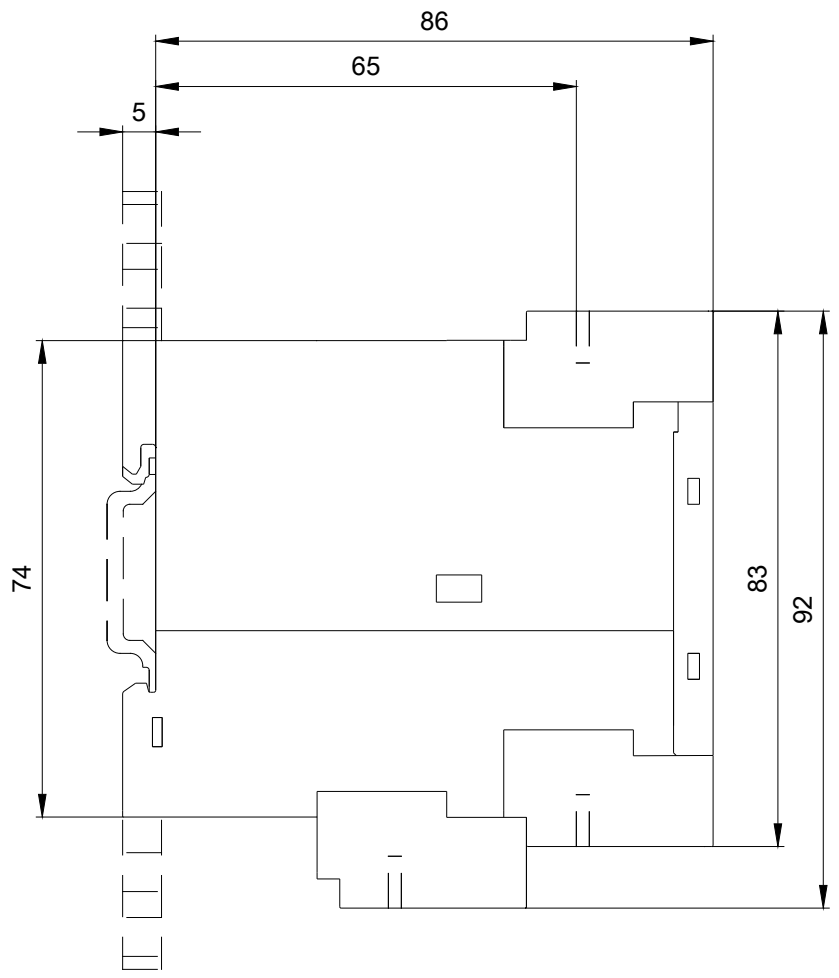
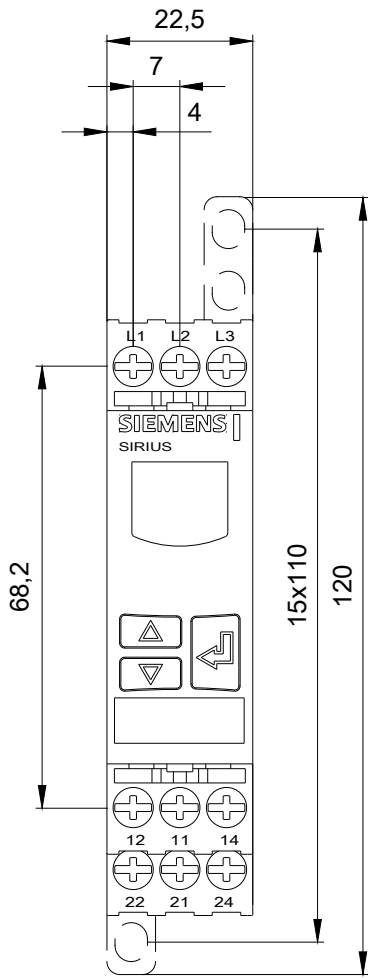

last modified:

06/06/2019