

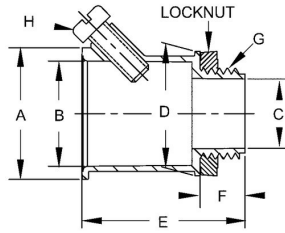

FLEXIBLE METAL SCREW-IN AND SET-SCREW TYPE CONNECTORS AND COUPLINGS

Set Screw Connectors Die Cast Zinc
N/A

B65.1



Catalog #: 2632

APPLICATIONS

For use in dry locations to bond flexible metal conduit to a box or enclosure
N/A

PRODUCT FEATURES

Rugged metallic construction insures mechanical protection for the raceway

UL LISTED

Standard 514B, UL Listed E195969

CSA

C22.2 No. 18

GENERAL PRODUCT INFORMATION

Trade Size: 1/2 in.

DRAWING DIMENSIONS

Dimension A:	1-3/16 in.
Dimension B:	61/64 in.
Dimension C:	39/64 in.
Dimension D:	1-1/8 in.
Dimension E:	1-1/2 in.
Dimension F:	3/64 in.
Dimension G:	1/2-14 NPSM
Dimension H:	10-24 x 1/2 in.

PACKAGING

Package Type:	Carton
Std. Pkg.:	25
Ship Carton Qty.:	250
Product UPC-A Labeled:	No
Weight (Lbs. Per/C):	9.70
Ship Carton Length (in.):	19.00
Ship Carton Width (in.):	10.62
Ship Carton Height (in.):	5.31
Ctn Weight (Lbs.):	24.25
UPC Number:	050169026328
I2of5:	50050169026323