

COORDINATE SWITCH, 22MM, ROUND, PLASTIC, BLACK,
 PLASTIC FRONT RING BLACK, 4 SWITCH POSITIONS,
 MOMENTARY CONTACT, W/O MECHANICAL INTERLOCK IN O
 POSITION, WITH HOLDER, 1NO PER DIRECTION



Figure similar

Enclosure	
Shape of the enclosure front	round
Material of the enclosure	plastic
Actuator	
Design of the operating mechanism	joystick
Number of switching positions	4
Button	
Design of the button	raised
Color of the button	black
Front ring	
Product component front ring	Yes
Material of the front ring	plastic
Color of the front ring	black
General technical data	
Type of voltage	
• of the operating voltage	AC/DC

Protection class IP	IP65
Vibration resistance	
<ul style="list-style-type: none"> • acc. to IEC 60068-2-6 	20 ... 200 Hz: 5g
Operating frequency maximum	1 000 1/h
Mechanical service life (switching cycles)	
<ul style="list-style-type: none"> • typical 	500 000
Equipment marking	
<ul style="list-style-type: none"> • acc. to DIN 40719 extended according to IEC 204-2 acc. to IEC 750 	S
<ul style="list-style-type: none"> • acc. to DIN EN 61346-2 	S
<ul style="list-style-type: none"> • acc. to DIN EN 81346-2 	S
Operating voltage	
<ul style="list-style-type: none"> • rated value 	5 ... 500 V

Auxiliary circuit

Number of NC contacts	
<ul style="list-style-type: none"> • for auxiliary contacts 	0
Number of NO contacts	
<ul style="list-style-type: none"> • for auxiliary contacts 	4
Number of CO contacts	
<ul style="list-style-type: none"> • for auxiliary contacts 	0

Connections/Terminals

Type of electrical connection	screw-type terminals
Tightening torque of the screws in the bracket	0.8 N·m



Ambient conditions

Ambient temperature	
<ul style="list-style-type: none"> • during operation 	-25 ... +70 °C
<ul style="list-style-type: none"> • during storage 	-40 ... +80 °C

Installation/ mounting/ dimensions

Mounting type	front mounting
Height	45 mm
Width	45 mm
Depth	137 mm
Shape of the installation opening	round
Mounting diameter	22 mm
Mounting height	77 mm
Installation width	30 mm

Certificates/approvals

General Product Approval	Declaration of Conformity	Test Certificates	other		
 CCC		 EG-Konf.	Special Test Certificate	Environmental Confirmations	Miscellaneous

other
Confirmation

Further information

Information- and Downloadcenter (Catalogs, Brochures,...)

<http://www.siemens.com/industrial-controls/catalogs>

Industry Mall (Online ordering system)

<https://mall.industry.siemens.com/mall/en/en/Catalog/product?mlfb=3SB1208-7JV01>

Cax online generator

<http://support.automation.siemens.com/WW/CAXorder/default.aspx?lang=en&mlfb=3SB1208-7JV01>

Service&Support (Manuals, Certificates, Characteristics, FAQs,...)

<https://support.industry.siemens.com/cs/ww/en/ps/3SB1208-7JV01>

Image database (product images, 2D dimension drawings, 3D models, device circuit diagrams, EPLAN macros, ...)

http://www.automation.siemens.com/bilddb/cax_de.aspx?mlfb=3SB1208-7JV01&lang=en

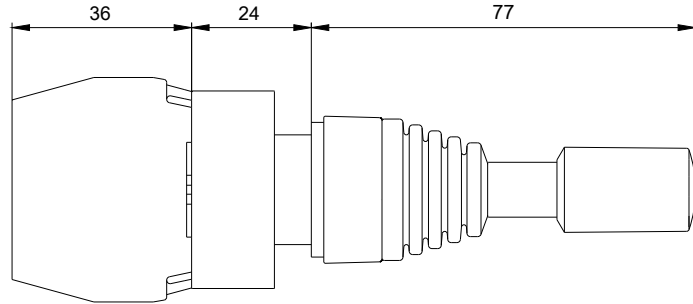
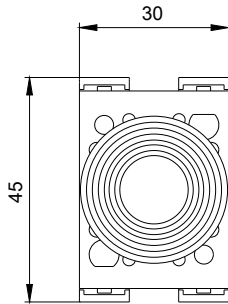

Date:

Name:

Format/Size: DIN A4

last modified:

07/27/2017