

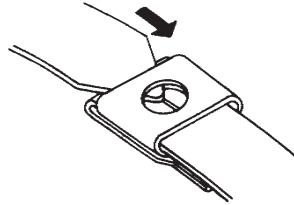

## Stainless Steel Cable Ties and Accessories

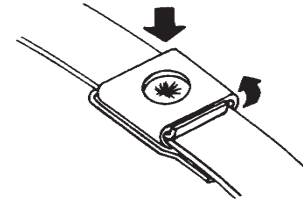

After wrapping the object to be tied, insert the free end of the tie through the buckle and into the tool.



Squeeze the handle of the tool to create the dual lock and cut off the tail. The cable tie forms a low-profile dual lock.



- The tail is formed into a fold lock behind the buckle
- The tool forces a dimple in the band into a hole in the buckle

### Dual Lock

Thomas & Betts has a complete package of stainless steel cable ties and accessories that are easy to apply and superior in quality. These products have been designed for tying, lashing and identification applications in demanding environments such as boiler rooms, chemical plants, refineries, pulp/paper mills, shipyards and offshore oil platforms. They are made of a variety of high-quality stainless steel materials which offer excellent corrosion resistance, high temperature and durability characteristics. There is also a variety of high-quality installation and identification tools to complete your cable tie accessory needs.

For cable bundling, I.D. tags and other general bundling applications – especially in hazardous environments – Thomas & Betts Stainless Steel Cable Ties provide a strong, safe, permanent installation with a unique, dual lock.

The Type 304 stainless steel ties are completely fireproof – no toxic fumes, no sagging cables. They are extremely resistant to corrosion and UV light, with the ability to withstand the harshest temperature extremes. Yet they are surprisingly economical.

The low-profile ties are fast and easy to apply. A quick squeeze of the installation tool forms two strong locks – a dimple lock and a fold lock.

Their two-piece configuration adds to its versatility. Available in standard lengths to wrap bundle diameters from 1 to 10 inches, Thomas & Betts Stainless Steel Cable Ties can be supplied in other lengths on special order.

Low-profile Thomas & Betts Stainless Steel Ties are fireproof and resist corrosion, UV light and extreme weather conditions for safe, permanent cable bundling.

### Installation Hand Tool

The installation hand tool is a lightweight, pocket size hand tool which quickly and easily applies the stainless steel cable ties.

To use, simply separate the pull-up handle from the body, push the release lever down and insert the clamp tail as far as possible. Squeeze the pull-up handle until the band is tight. Finally, move the pull-up handle to the locking/cut-off position by moving it away from the body as far as it will go. Then squeeze to form the dual lock and cut off the excess tail.

## Catalogue Number System

CABLE TIE TYPE
<b>SS</b> = Two-piece solid stainless steel cable tie, Type 304
<b>TYS</b> = Multi-lock stainless steel cable tie, Type 316
<b>SSR</b> = Reusable stainless steel cable tie, Type 200/300
<b>SSH</b> = Heavy-duty stainless steel clamp, Type 201
<b>TS</b> = Roller bar locking stainless steel cable tie, Type 302/304
<b>LS</b> = Ball locking stainless steel cable tie, Type 302/304/316

	Bundle Diameter	Tensile Strength	Width	Length	Weight
Cat. No.	For Bundle Dia. of (in./mm)	Tensile Strength (lb./N)	Width (in./mm)	Length (in./mm)	Weight (lb./kg)
<b>SS10-250</b>	2/51	200/890	0.25/6.35	10.0/254	1.1/4.89
<b>SS17-250</b>	4/101	200/890	0.25/6.35	16.5/419	1.8/8.00

## Stainless Steel Cable Ties and Accessories

### SS – Two-Piece Solid

Strong, slip-free ties with a unique dual lock

- Low-profile, single wrap ties
- Dual locking mechanism
- No slipping



Cat. No.	For Bundle Dia. of (in./mm)	Tensile Strength (lb./N)	Width (in./mm)	Length (in./mm)	Weight (lb./kg)	Std. Pkg.
<b>Mini Stainless Steel Cable Ties</b>						
<b>SS7-180</b>	1/25	100/444.8	0.18/4.5	6.5/165	0.70/0.32	100
<b>SS10-180</b>	2/51			10.0/254	0.90/0.41	
<b>SS16-180</b>	4/102			16.0/406	1.40/0.64	
<b>SS23-180</b>	6/152			22.5/572	1.85/0.84	
<b>SS29-180</b>	8/203			29.0/737	2.35/1.07	
<b>Standard Stainless Steel Cable Ties</b>						
<b>SS10-250</b>	2/51	250/1,112	0.25/6.35	10.0/254	1.10/0.50	100
<b>SS17-250</b>	4/102			16.5/419	1.80/0.82	
<b>SS23-250</b>	6/152			22.5/572	2.50/1.13	
<b>SS29-250</b>	8/203			29.0/737	3.20/1.45	
<b>SS35-250</b>	10/254			35.0/889	3.80/1.72	

304 Stainless Steel  
0.015 in. (0.38mm) Thickness  
**NOTE:** Other lengths available on special request.  
Add suffix -316 for 316 Stainless Steel.

### Mini Tie Installation Tool

Perfect for mini-sized stainless steel ties

- Pocket-sized, light weight
- Applies mini-size stainless steel ties



Cat. No.	Description	Weight (lb./kg)	Std. Pkg.
<b>WTA290</b>	Hand tool to apply mini stainless steel cable ties; easy-to-use tool applies tension, locks tie with the dual lock, and cuts off band flush with top surface of buckle	1.17/0.53	1

### Standard Tie Installation Tool

Pocket-sized hand tool for quick and easy cable tie installations

- Lightweight
- Applies standard-size stainless steel ties



Cat. No.	Description	Weight (lb./kg)	Std. Pkg.
<b>WTA250</b>	Hand tool to apply standard stainless steel cable ties; easy-to-use tool applies tension, locks tie with the dual lock, and cuts off band flush with top surface of buckle	1.17/0.53	1

## Stainless Steel Cable Ties and Accessories

### TYS – Multi-Lok™ Self-Locking



#### Strong — holds in excess of 200 lb. — and self locking

- Corrosion-resistant, providing a safe, strong, worry-free hold
- Unique, self-locking, multiple-locking system holds in excess of 200 lb.
- Manufactured from Type 316 stainless steel
- Available in two widths and various lengths

Cat. No.	Tensile Strength (lb./N)	Width (in./mm)	Length (in./mm)	Weight (lb./kg)	Std. Pkg.
<b>Type 316 Stainless Steel – Uncoated</b>					
TYS6-280	250/1,112	0.28/7.00	6/150	0.66/0.30	100
TYS9-280			9/225	0.99/0.45	
TYS12-280			12/300	1.32/0.60	
TYS18-280			18/450	1.76/0.80	
TYS24-280			24/610	2.64/1.20	
TYS6-470		0.47/12.00	6/150	1.10/0.50	
TYS9-470			9/225	1.65/0.75	
TYS12-470			12/300	2.20/1.00	
TYS18-470			18/450	2.97/1.35	
TYS24-470			24/610	4.29/1.95	

0.010 in. (0.245mm) Thickness

#### How it works:

As the free end of the Multi-Lok™ tie passes through the buckle, three separate teeth (four teeth in the 12 mm Multi-Lok™) mesh with corresponding slots in the band, automatically locking the tie as it is being tensioned.

- Nylon 11 weather-resistant coating is unaffected by UV sunlight, resistant to corrosion, chemicals, weathering and protects cable insulation
- Coated with halogen-free, non-toxic black nylon 11

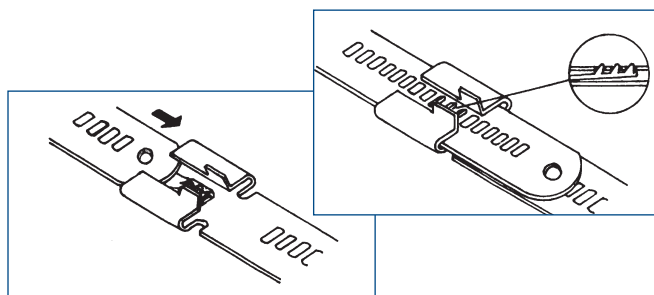

Cat. No.	Tensile Strength (lb./N)	Width (in./mm)	Length (in./mm)	Weight (lb./kg)	Std. Pkg.
<b>Type 316 Stainless Steel – Nylon 11 Coated</b>					
TYS6-280C	250/1,112	0.28/7.00	6/150	0.66/0.30	100
TYS9-280C			9/225	0.99/0.45	
TYS12-280C			12/300	1.32/0.60	
TYS18-280C			18/450	1.76/0.80	
TYS24-280C			24/610	2.64/1.20	
TYS6-470C		0.47/12.00	6/150	1.10/0.50	
TYS9-470C			9/225	1.65/0.75	
TYS12-470C			12/300	2.20/1.00	
TYS18-470C			18/450	2.97/1.35	
TYS24-470C			24/610	4.29/1.95	

0.010 in. (0.245mm) Thickness

## Stainless Steel Cable Ties and Accessories

### SSR – Reusable

#### Ties to use and reuse with quickness and ease!

- Made of high-strength, corrosion-resistant 200/300 Series stainless steel
- Coated with a non-toxic, halogen-free, low-smoke Nylon 11, protecting cables from damage or interference due to direct contact with the stainless steel
- Nylon 11 is also chemical and weather-resistant, UV-protective, extremely flexible at low temperature, user-friendly on installer's hands and easy on bundles
- Unique buckle design for quick, easy application and re-use

1. Insert cable tie tail through holding tabs and locking emboss.
2. Bend cable tie tail up.
3. Insert cable tie tail back through holding tabs, creating as tight a bend as possible. For increased tensile strength follow steps #4 and #5.
4. Bend cable tie tail up.
5. Fold cable tie tail over holding tabs.

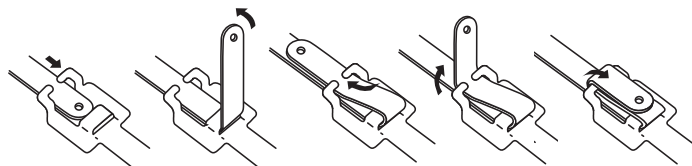

Cat. No.	Tensile Strength (lb./N)	Width (in./mm)	Length (in./mm)	Weight (lb./kg)	Std. Pkg.
<b>Reusable Stainless Steel Cable Ties – Coated</b>					
<b>SSR6-250C</b>	75/333.60	0.25/6.35	6/152	1.4/0.64	100
<b>SSR9-250C</b>			9/229	1.8/0.82	
<b>SSR12-250C</b>			12/305	2.1/0.95	
<b>SSR18-250C</b>			18/457	3.0/1.36	
<b>SSR24-250C</b>			24/610	3.7/1.68	
<b>SSR6-375C</b>	100/444.80	0.38/9.53	6/152	1.8/0.82	
<b>SSR9-375C</b>			9/229	2.0/0.91	
<b>SSR12-375C</b>			12/305	3.1/1.41	
<b>SSR18-375C</b>			18/457	4.4/2.00	
<b>SSR24-375C</b>			24/610	6.6/2.99	
<b>SSR30-375C</b>			30/762	7.0/3.18	
<b>SSR36-375C</b>			36/914	8.3/3.76	



**WTAE200**  
Cable Tie Tensioner

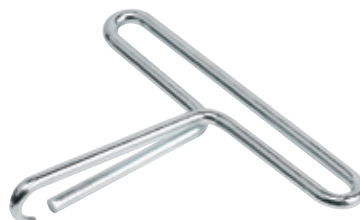

**WTAE201**  
Tensioning Hook



**DAS250**  
Pistol Grip Tensioning Tool

(WTAE tools for use with type TYS – TYS C Series Cable ties)



Cat. No.	Description	Weight (lb./kg)	Std. Pkg.
<b>Tensioning Tools</b>			
<b>WTAE200</b>	Cable Tie Tensioner: For tensioning Reusable Ties and Multi-Lok™ Ties	0.6/0.27	1
<b>WTAE201</b>	Tensioning Hook: For tensioning Reusable Ties and Multi-Lok™ Ties	0.1/0.05	
<b>DAS250</b>	Pistol Grip Tensioning Tool: For installing Multi-Lok™, Ball Lock, & Roller Bar Lock SS Ties	1.0/0.45	

## Stainless Steel Cable Ties and Accessories

### SSH – Heavy-Duty Clamp



**Pre-assembled for single or double wrapping!**

- Double-wrapped clamps provide **extra** strength
- Available in various lengths, widths, and thicknesses



Cat. No.	Max. Dia. Once Around (in./mm)	Max. Dia. Twice Around (in./mm)	Total Length (in./mm)	Tensile Strength Single Wrap (lb./N)	Band Width (in./mm)	Band Thickness (in./mm)	Weight (lb./kg)	Std. Pkg.
<b>Heavy-Duty Free-End Stainless Steel Clamps — Type 201</b>								
SSH10-250	2/50	–	10/25	450/2002	0.25/6.35	0.02/0.51	2.2/1.00	100
SSH16-250	3.5/88	1.5/38	16/40				3.1/1.41	
SSH18-500	4/101	2/50	18/45				10.5/4.76	
SSH21-625	5/127	2.5/63	21/53				15.1/6.85	
SSH31-500	8/203	4/101	31/78	1,400/6228	0.5/12.70	0.03/0.76	4.7/2.13	25
SSH34-250	9/228	4.5/114	34/86	450/2002	0.25/6.35	0.02/0.51	5.6/2.54	100
SSH37-750	10/254	5/127	37/93	2,000/8896	0.75/19.05	0.03/0.76	7.6/3.45	25
SSH44-375	12/304	6/152	44/112	900/4003	0.38/9.53		3.6/1.69	
SSH50-750	14/355	7/177	50/127	2,000/8896	0.75/19.05		9.7/4.40	
SSH56-625	16/406	8/203	56/142	1,700/7562	0.63/15.88		9.0/4.08	
SSH62-750	18/457	9/228	62/157	2,000/8896	0.75/19.05		11.6/5.26	
SSH69-625	20/508	10/254	69/175	1,700/7562	0.63/15.88		10.7/4.86	

Type 201 Stainless Steel  
Other Free-End Clamp sizes and metals are available on special order.

### Apply tension, cut and secure with confidence!



**WTJ020**

Lightweight pocket-sized tool to install 1/4 in. and 3/8 in. wide Free-End Clamps. This tool also applies tension and has a built-in cutter.



**WTC075**

Designed to install 1/4 in. to 5/8 in. wide Free-End Clamps. The lightweight, ratchet-action tool tension cuts and secures the buckle tab.



**WTC001**

A drop-forged tool with tensioning capability to do all 1/4 in. to 3/4 in. Free-End Clamp sizes.

Cat. No.	Description	Weight (lb./kg)	Std. Pkg.
<b>Installation Tools</b>			
WTJ020	Compact Free End Stainless Steel Cable Tie Installation Tool for 1/4 in. to 3/8 in. sizes	1.1/0.50	1
WTC075	Pistol Grip Free End Stainless Steel Cable Tie Installation Tool for 1/4 in. to 5/8 in. sizes	2.6/1.18	
WTC001	Free End Stainless Steel Cable Tie Installation Tool for all sizes	4.4/2.00	



## Stainless Steel Cable Ties and Accessories

### Specifications



Mini Stainless Steel Cable Ties



Standard Stainless Steel Cable Ties



Reusable Stainless Steel Cable Ties



Multi-Lok™ Ties — Uncoated



Multi-Lok™ Ties — Coated



Free-End Clamps

Cat. No.		Width (in./mm)	Length (in./mm)	Thickness (in./mm)	Max. Dia. Single Wrap (in./mm)	Max. Dia. Double Wrap (in./mm)					
<b>Specifications for Stainless Steel Ties</b>											
SS7-180	–	0.18/4.50	6.5/165	0.02/0.51	1.7/43	(single wrap only)					
SS10-180	–		10/254		2.8/71						
SS16-180	–		16/406		4.7/119						
SS23-180	–		22.5/572		6/152	–					
SS29-180	–		29.0/737		8/203	–					
SS10-250	–	0.25/6.35	10/254		0.02/0.51	2.1/153	(single wrap only)				
SS17-250	–		16.5/419			4.3/109					
SS23-250	–		22.5/572			6.5/165					
SS29-250	–		29/737			8.5/215					
SS35-250	–		35/889			10.5/265					
SSR6-250C	–	0.25/6.35	6/152			0.02/0.51	1.5/38	N/A			
SSR9-250C	–		9/229				2.5/63		1.1/28		
SSR12-250C	–		12/305				3.4/86	1.5/38			
SSR18-250C	–		18/457				5.4/137	2.5/64			
SSR24-250C	–		24/610				7.3/185	3.5/89			
SSR6-375C	–	0.38/9.53	6/152	0.02/0.51			1.5/38	N/A			
SSR9-375C	–		9/229				2.5/63		1.1/28		
SSR12-375C	–		12/305				3.4/86	1.5/38			
SSR18-375C	–		18/457				5.4/137	2.5/64			
SSR24-375C	–		24/610				7.3/185	3.5/89			
SSR30-375C	–	–	30/762		–		9.1/231	4.4/112			
SSR36-375C	–	–	36/914		–		11.0/280	5.3/135			
<b>Uncoated Nylon 11 Coated</b>											
TYS6-280	TYS6-280C	0.28/7.00	6/152		0.01/0.25		1.9/48	(single wrap only)			
TYS9-280	TYS9-280C		9/229				2.8/71				
TYS12-280	TYS12-280C		12/305			3.8/96					
TYS18-280	TYS18-280C		18/457			5.7/144					
TYS24-280	TYS24-280C		24/610			7.6/193					
TYS6-470	TYS6-470C	0.47/12.00	6/152			0.01/0.25	1.9/48		(single wrap only)		
TYS9-470	TYS9-470C		9/229				2.8/71				
TYS12-470	TYS12-470C		12/305	3.8/96							
TYS18-470	TYS18-470C		18/457	5.7/144							
TYS24-470	TYS24-470C		24/610	7.6/193							
SSH10-250	–	0.25/6.35	10/250	0.02/0.51			2.0/50	N/A			
SSH16-250	–		16/400				3.5/88			1.5/38	
SSH19-250	–		19/480				5.0/127	2.5/64			
SSH27-250	–		27/680				7.0/177	3.5/89			
SSH34-250	–		34/860				9.0/228	4.5/114			
SSH16-375	–	0.38/9.53	16/400		0.02/0.51		3.5/88	1.5/38			
SSH44-375	–		44/1,120				12.0/304		6.0/152		
SSH18-500	–	0.5/12.70	18/460				0.03/0.76	4.0/101	2.0/5.0		
SSH31-500	–		31/780					8.0/203		4.0/101	
SSH21-625	–	0.63/15.88	21/530					0.03/0.76	5.0/127	2.5/64	
SSH56-625	–		56/1,420			16.0/406			8.0/203		
SSH69-625	–		69/1,750			20.0/508			10.0/254		
SSH24-750	–	0.75/19.05	24/600			0.03/0.76			6.0/152	3.0/76	
SSH37-750	–		37/940						10.0/254		5.0/127
SSH50-750	–		50/1,270						14.0/355		7.0/177
SSH62-750	–		62/1,570	18.0/457					9.0/228		

Specifications (cont'd)



Cat. No.		Stainless Steel Type	Coating or Finish	Min. Loop Tensile Strength Single Wrap (lb./N)	Min. Loop Tensile Strength Double Wrap (lb./N)	Application Tools Used	Max. Dia. Single Wrap (in./mm)
<b>Specifications for Stainless Steel Ties (cont'd)</b>							
SS7-180		304	Dull to Bright	100/445	(single wrap only)	WTA290	<ul style="list-style-type: none"> <li>• Wire/cable bundling</li> <li>• I.D. tagging</li> </ul>
SS10-180							
SS16-180							
SS23-180							
SS29-180							
SS10-250							
SS17-250		200/300	Nylon 11 Coated (Uncoated or other colours available on special order)	200/890		WTA250	
SS23-250							
SS29-250							
SS35-250							
SSR6-250C							
SSR9-250C							
SSR12-250C		200/300	Nylon 11 Coated (Uncoated or other colours available on special order)	75/334	300/1,334	WTAE200	<ul style="list-style-type: none"> <li>• Reusable</li> <li>• Cable bundling</li> <li>• Oil rigs</li> <li>• Telecommunications towers</li> <li>• Hazardous and corrosive environments</li> <li>• Cable trays</li> </ul>
SSR18-250C							
SSR24-250C							
SSR6-375C							
SSR9-375C							
SSR12-375C							
SSR18-375C		200/300	Nylon 11 Coated (Uncoated or other colours available on special order)	100/445	500/2,224	WTAE201	
SSR24-375C							
SSR30-375C							
SSR36-375C							
<b>Uncoated Nylon 11 Coated (cont'd)</b>							
TYS6-280	TYS6-280C	316	Uncoated or Nylon 11 Coated Black	250/1,112	(single wrap only)	WTAE200	<ul style="list-style-type: none"> <li>• Self-locking</li> <li>• Cable bundling</li> <li>• Hazardous and corrosive environments</li> </ul>
TYS9-280	TYS9-280C						
TYS12-280	TYS12-280C						
TYS18-280	TYS18-280C					WTAE201	
TYS24-280	TYS24-280C						
TYS6-470	TYS6-470C						
TYS9-470	TYS9-470C					WTC075	
TYS12-470	TYS12-470C						
TYS18-470	TYS18-470C						
TYS24-470	TYS24-470C						
SSH10-250		201	Bright	450/2,002	1,200/5,338	WTJ020 WTC075 WTC001	<ul style="list-style-type: none"> <li>• Industrial hoses</li> <li>• Cable bundling</li> <li>• High strength</li> </ul>
SSH16-250							
SSH19-250							
SSH27-250							
SSH34-250				WTC075 WTC001			
SSH16-375							
SSH44-375							
SSH18-500							
SSH31-500				WTC001			
SSH21-625							
SSH56-625							
SSH69-625							
SSH24-750							
SSH37-750							
SSH50-750		WTC001					
SSH62-750							
				2,000/8,896	5,000/22,240		

Ty-Rap® Stainless Steel Cable Ties have passed a variety of mechanical, environmental, and electrical tests. Other data can be made available upon request. S.S. Series also available in (316) Stainless.

## Stainless Steel Cable Ties and Accessories

### Tools and Accessories

#### Boiler rooms, shipyards, or off-shore oil platforms — a match for any severe environment!

- Stainless steel strap cable ties have been designed for high-temperature applications and for use in areas of harsh, corrosive environments
- Rated at 200-lb. tensile strength
- Smooth edges protect both the cable insulation and the installer



Cat. No.	Body Width (in.)	Length (in.)	Max. Wire Bundle Dia. (in.)	Tensile Strength (lb.)	Std. Pkg.
<b>Ty-Rap® Stainless Steel Strap Cable Ties</b>					
<b>TYS8</b>	0.310	10.65	2	200	100
<b>TYS14</b>	0.310	14.65	4	200	50
<b>TYS22</b>	0.310	22.65	6	200	50
<b>TYS28</b>	0.310	28.65	8	200	50

Note: Use WT3S Tool for tensioning  
 Cannot be coated with any covering material  
 Made of 316 stainless steel

### 1,000-ft. reel to cut your desired length!



Cat. No.	Description	Width (in./mm)	Tensile Strength (lb./N)	Std. Pkg.
<b>Ty-Rap® Stainless Steel Strapping on a Reel</b>				
<b>TYS1000</b>	1,000-ft. of strap, 2 reels of 500 ft. each	0.31/7.87	200/889.60	1

Stainless steel ties of virtually any length can be produced from the 1,000-ft. reel in combination with the matching head.

Note: Use WT3S tool for tensioning and cutoff

### A perfect mate with cable ties for tensioning



WT3S



DAS250

Cat. No.	Description	Std. Pkg.
<b>Ty-Rap® Stainless Steel Cable Tie Installation Tools</b>		
<b>WT3S</b>	Installs strapping ties	1
<b>DAS250</b>	Installs Multi-Lok™, ball lock, and roller bar lock stainless steel ties	

### Lockable heads for stainless steel strapping



Cat. No.	Description	Std. Pkg.
<b>Ty-Rap® Stainless Steel Strapping Locking Heads</b>		
<b>TYS5200H</b>	Heads only for stainless strapping	50

### Long-lasting anchor hold



Cat. No.	Description	Std. Pkg.
<b>Ty-Rap® Stainless Steel Mounting Base</b>		
<b>TCS25</b>	Mounting bases for stainless steel ties	50



## Stainless Steel Cable Ties and Accessories

### Identify cable bundles with permanent, stainless steel imprintable tags

- Apply Type 304 stainless steel tags with stainless steel cable ties
- Easy-to-use — slip a tie through the slots in the tag and fasten with the installaton tool
- Works with 1/4 in. wide ties
- 0.015 in. Thickness



Cat. No.	Width (in./mm)	Length (in./mm)	Weight (lb./N)	Std. Pkg.
<b>I.D. Tagging System</b>				
<b>SSID100</b>	0.75/19.05	2.0/50.80	0.5/2.22	100
<b>SSID101</b>	1.50/38.10	2.5/63.50	1.2/5.34	
<b>SSID102</b>	0.75/19.05	3.5/88.90	0.8/3.56	

Packaging Quantity: 100/box

**Note:** Customized pre-embossed tags are available. Please consult Regional Sales Office for details. Add suffix (316) for 316 Stainless Steel.

### S.S. Tape Embossing System



Cat. No.	Description	Weight	
		lb.	kg
<b>S.S. Tape Embossing System</b>			
<b>WTID400</b>	Hand-held tool for embossing S.S. I.D. Tap	2.57	1.17
<b>WTID405</b>	Replacement S.S. tape (21' long, 1/2" wide)	0.18	0.01

### No second guessing — quickly and accurately position I.D. tags!

- Imprint Thomas & Betts stainless steel I.D. tags
- Includes special tag holder for secure positioning and a 3/32 in. character imprinting wheel, standard (no substitutions allowed)



Cat. No.	Description	Weight (lb./N)
<b>I.D. Tagging System</b>		
<b>WTID200</b>	I.D. Tag Imprinter	29.5/131.2
<b>WTID290</b>	3/32 in. Character Imprinting Wheel	-
<b>WTID281</b>	1/8 in. Character Imprinting Wheel	
<b>WTID283</b>	3/16 in. Character Imprinting Wheel	
<b>WTID204</b>	(Kit) WTID200 and WTID283	

Packaging Quantity: 1/box

## Stainless Steel Cable Ties and Accessories

### LS - Heavy-Duty Ball-Lock Mechanism

Engineered to withstand the harshest environments!



YLS-7.9-200BC



LS-4.6-200A

These one-piece, self-locking stainless steel cable ties offer quick and easy installation — no crimping or folding required — and a strong, reliable lock. Choose among a variety of sizes and materials to meet all of your wire and cable bundling needs, even in the most extreme environments.

#### Safer, Stronger, Faster

- Self-locking — no time-consuming crimping or folding required
- Stainless steel ball in low-profile, wedge-shaped head locks tie securely in place
- Angled tail enables fast, easy insertion
- Rounded edges and smooth surfaces protect installer's hands
- Engineered with an average ultimate failure point of up to twice the listed strength

#### Wide range of sizes

- Six standard lengths cover most applications with custom lengths available

#### Three materials suit a variety of environments

- 302/304 grade stainless steel for standard applications
- 316 grade (marine-grade) stainless steel for extra corrosion resistance
- 316 grade (marine-grade) stainless steel, fully coated with low-smoke, halogen-free polyester to withstand continuous exposure to salt spray, sunlight, petroleum and chemicals

#### Typical Applications

- Offshore drilling
- Petrochemical processing
- Shipbuilding
- Food and beverage processing
- Pharmaceutical processing

#### Specifications

- Operating Temp. Range:  
Uncoated: -60°C to 300°C (-76°F to 572°F)  
Coated: -60°C to 150°C (-76°F to 302°F)
- Approvals/Standards: CSA, UL, CE, Lloyd's Register, Germanischer Lloyd, American Bureau of Shipbuilding, Det Norske Veritas, RoHS compliant
- Uncoated: CSA approved

#### Application Tool

DAS-250 Hand Tool (adjustable tension, automatic cut off), CT6 and CT3



### Ordering Information



Cat. No. Uncoated 302/304 Grade Stainless Steel	Cat. No. Uncoated 316 Grade Stainless Steel	Cat. No. Fully Polyester Coated 316 Grade Stainless Steel	Length (in./mm)	Width (in./mm)	Max. Bundle Dia. (in./mm)	Tensile Strength (lb./N)	Std. Pkg.	Recommended Tooling
LS-4.6-200A	LS-4.6-200B	YLS-4.6-200BC	7.9/201	0.18/4.6	2.0/51	200/444.8	50	DAS-250, CT6, CT3
LS-4.6-360A	LS-4.6-360B	YLS-4.6-360BC	14.2/360		4.0/102			
LS-4.6-520A	LS-4.6-520B	YLS-4.6-520BC	20.5/520		6.0/152			
LS-4.6-680A	LS-4.6-680B	YLS-4.6-680BC	26.7/679		8.0/203			
LS-4.6-840A	LS-4.6-840B	—	33.0/838		10.0/254			
LS-7.9-200A	LS-7.9-200B	YLS-7.9-200BC	7.9/201	0.31/7.9	2.0/51	450/1112.0		
LS-7.9-360A	LS-7.9-360B	YLS-7.9-360BC	14.2/360		4.0/102			
LS-7.9-520A	LS-7.9-520B	YLS-7.9-520BC	20.5/520		6.0/152			
LS-7.9-680A	LS-7.9-680B	YLS-7.9-680BC	26.7/679		8.0/203			
LS-7.9-840A	LS-7.9-840B	—	33.0/838		10.0/254			
LS-7.9-1010A	LS-7.9-1010B	—	41.3/1050		12.5/318			



## Stainless Steel Cable Ties and Accessories

### Ty-Met™ stainless steel retained-tension ball-lock cable ties

Wave-form spring crimp eliminates movement—even in high-vibration applications

Ty-Met™ stainless steel retained-tension ball-lock cable ties from Thomas & Betts combine the convenience of a ball-lock fastening mechanism with a spring crimp that maintains tension after installation. This new feature helps to ensure that the ties won't slide down the cable bundle after they're installed — making them the ideal choice for high-vibration applications.

- Specially formed spring crimp creates consistent tension on the tie for firm positioning
- High wave-form crimp provides positive clamping in high-vibration applications
- Crimp channel offers a path for a trace wire with protection from crushing and shorts
- Ball-lock mechanism is easy to assemble and adjust for tension
- Ties available in both Type 304 stainless steel and Type 316 marine-grade stainless steel for extended life in highly corrosive environments
- Choose T&B DAS-250 application tool for installation

#### Applications

- Shipbuilding
- Industrial
- Oil and gas
- Heavy equipment and trucking
- Wind power
- Solar energy

#### Specifications

- Material: Type 304 or Type 316 stainless steel
- Operating temperature : -112° F to 572° F (-80° C to 300° C)
- Certifications/ compliances :  
UL/EN/CSA62275 Type 2S rated for AH-1 plenum

Cat. No.	Length		Width		Max. bundle diameter		Tensile strength		Std. pkg. qty.
	in.	mm	in.	mm	in.	mm	in.	mm	
Type 304 stainless steel—uncoated									
RS-4.6-200A	7.9	200	0.18	4.6	2	51	200	890	50
RS-4.6-260A	10.2	260	0.18	4.6	2.7	70	200	890	50
RS-4.6-360A	14.2	360	0.18	4.6	4	102	200	890	50
RS-4.6-520A	20.5	520	0.18	4.6	6	152	200	890	50
RS-4.6-680A	26.8	680	0.18	4.6	8	203	200	890	50
RS-7.9-200A	7.9	200	0.31	7.9	2	51	450	2002	50
RS-7.9-360A	14.2	360	0.31	7.9	4	102	450	2002	50
RS-7.9-520A	20.5	520	0.31	7.9	6	152	450	2002	50
RS-7.9-680A	26.8	680	0.31	7.9	8	203	450	2002	50
Type 316 marine-grade									
RS-4.6-200B	7.9	200	0.18	4.6	2	51	200	890	50
RS-4.6-260B	10.2	260	0.18	4.6	2.7	70	200	890	50
RS-4.6-360B	14.2	360	0.18	4.6	4	102	200	890	50
RS-4.6-520B	20.5	520	0.18	4.6	6	152	200	890	50
RS-4.6-680B	26.8	680	0.18	4.6	8	203	200	890	50
RS-7.9-200B	7.9	200	0.31	7.9	2	51	450	2002	50
RS-7.9-360B	14.2	360	0.31	7.9	4	102	450	2002	50
RS-7.9-520B	20.5	520	0.31	7.9	6	152	450	2002	50
RS-7.9-680B	26.8	680	0.31	7.9	8	203	450	2002	50

Note: Minimum bundle diameter for all cable ties listed above is 1" (25.4mm)